

12mm TOUGHENED OR 13.5mm TOUGHENED LAMINATE GLASS

TOP CONNECTION-  
M10 Hilti RE500 + HAS-RE S/S  
Rods at max. 400crs.

BOTTOM CONNECTION-  
M8 Hilti RE500 + HIS-RN S/S  
sleeve + CSK screw @ 400 crs.

**CONCRETE FIXING**

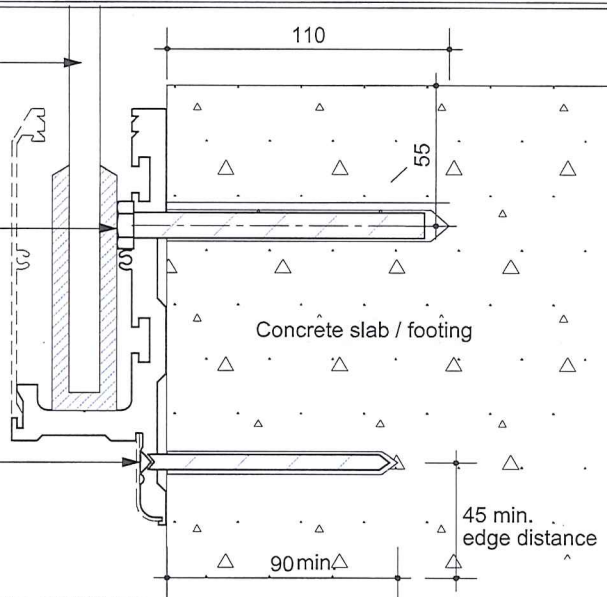

12mm TOUGHENED OR 13.5mm TOUGHENED LAMINATE GLASS

TOP CONNECTION-  
M10 S/S COACH BOLT  
M10 S/S coach screw at  
300 centres.

BOTTOM CONNECTION-  
Gauge 14 S/S screws at  
max. 225crs.

**TIMBER FIXING**

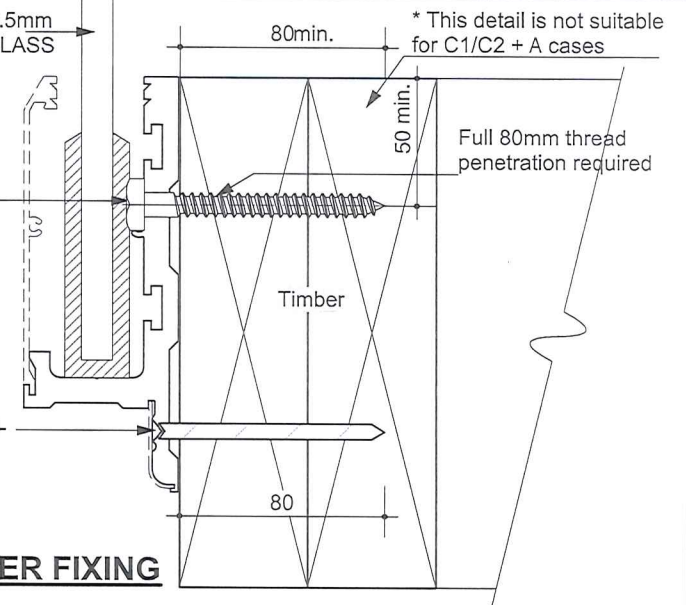

12mm TOUGHENED OR 13.5mm TOUGHENED LAMINATE GLASS

TOP CONNECTION-  
M10 S/S bolts @  
400mm crs. with  
30x30x2 S/S washers

Timber packer to suit

BOTTOM CONNECTION-  
M8 S/S bolts @ 400mm crs.  
with 30x30x2 S/S washers

**STEEL FIXING**

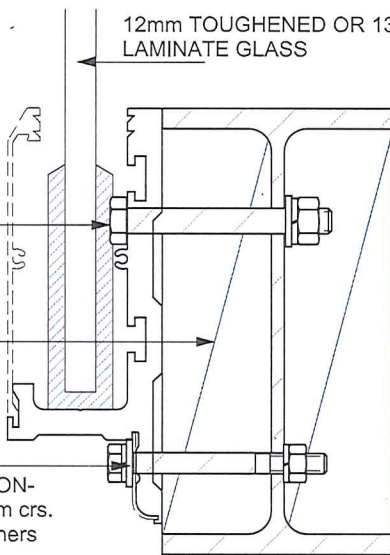

12mm TOUGHENED OR 13.5mm TOUGHENED LAMINATE GLASS

TOP CONNECTION-  
M10 S/S COACH BOLT at  
400crs. With 50x50x3 S/S  
Washers

BOTTOM CONNECTION-  
Gauge 14 S/S screws at max. 225crs.

**TIMBER FIXING**

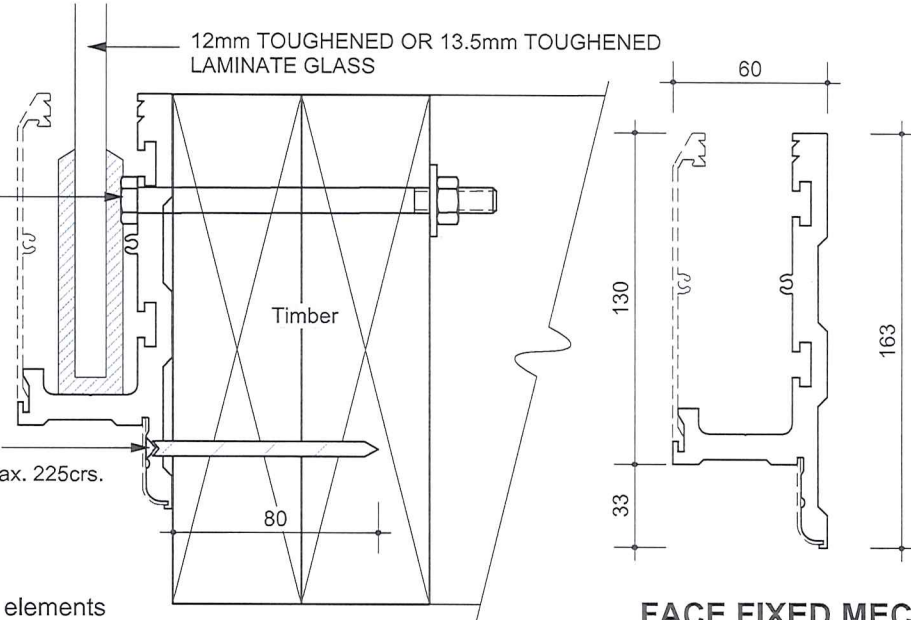

-Internal / External  
use up to high  
wind zone.  
-Occupancy  
Type A,A other  
B,E or C3, C1/C2.  
-Loading only.  
-Refer table 3.3  
AS/NZS 1170.  
Refer GS-10 and  
GS-11 Drawing  
for Handrail type.

**FACE FIXED MECHANICAL CHANNEL**



Drawing  
GS - 4

The design of the primary structural elements that support the balustrade must be carried out by a suitably qualified person to carry the loads imposed by the balustrade relevant to the occupancy type and building code requirements.